

DISTRICT OF SEHELDT

Bylaw No. 463, 2007

A Bylaw to close a portion of a Public Highway commonly known as the Boulevard and Wharf Road

WHEREAS Section 40 of the *Community Charter* provides that Council may by bylaw close a portion of a highway to traffic;

AND WHEREAS that portion of road shown on the attached reference plan forming part of this Bylaw as Schedule A is no longer required for road purposes;

AND WHEREAS the Boulevard-Wharf Road Bylaw No. 463, 2007 was adopted by Council to effect the road closure and included required notices in the local newspaper, and posted notice in the public notice posting place;

NOW THEREFORE, the Council of the District of Sechelt in open meeting assembled enacts as follows:

1. **TITLE**

This Bylaw may be cited for all purposes as "Boulevard-Wharf Road Closure Bylaw No. 463, 2007".

2. **PROVISIONS**

- (1) Those portions of road located within the boundaries of DL 303/304, Plan 2615, Group 1, NWD shown outlined on the reduced copy of the "Reference Plan to accompany District of Sechelt Road Closure Bylaw" attached to this Bylaw, and marked as Schedule 'A' and identified on the plan as 'Highway Lands' is hereby stopped up and closed to traffic.
- (2) The Mayor and Corporate Officer are hereby authorized to execute all documents as are necessary to effect the aforesaid transfer and disposition of land.
- (3) On deposit of all documentation for the closure the 'Highway Lands' are stopped up and closed to public traffic.

READ A FIRST TIME THIS 3rd DAY OF October, 2007

READ A SECOND TIME THIS 3rd DAY OF October, 2007

READ A THIRD TIME THIS 3rd DAY OF October, 2007

APPROVED BY THE MINISTRY OF TRANSPORTATION AND HIGHWAYS THIS
5th DAY OF October, 2007

ADOPTED THIS 17th DAY OF October, 2007

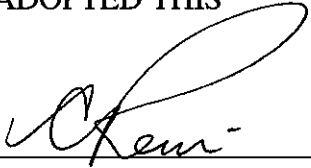

Mayor



Corporate Officer

I certify this to be a true copy and
accurate copy of District of Sechelt
"Boulevard-Wharf Road Closure
Bylaw No. 463, 2007"

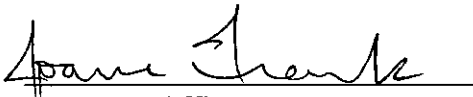

Corporate Officer

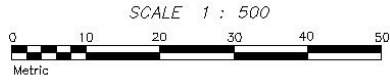

All distances are in Metres.

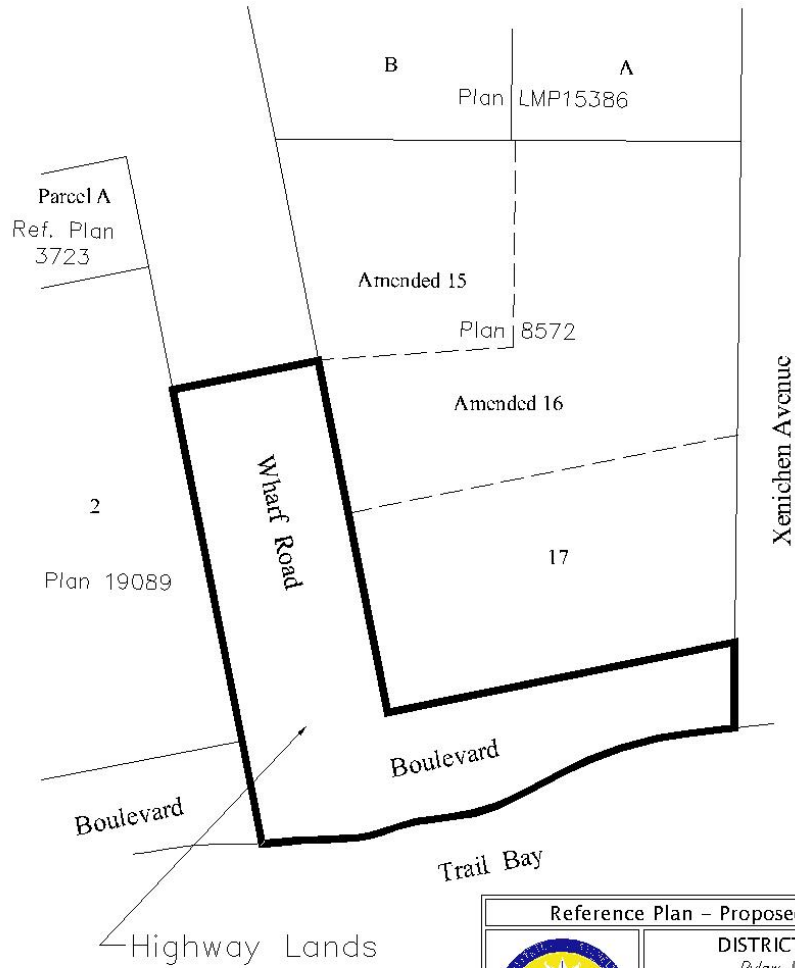

02/10/2007 - 8:10am, Export / Home / Export / C:\Documents\land\mapa_2007_05-07_10ref / Area_2002.mxd

Reference Plan – Proposed Road Closure	
	
DISTRICT OF SECHelt <i>Bylaw No. 463, 2007</i> Schedule "A" Boulevard / Wharf Road	
Scale = NTS	September 20, 2007
Rev. 0	